



# OutTeach

*Go Outside Expectations*





# Shining Stars Montessori Academy

1240 Randolph Street Northeast Washington, DC 20017

R. Rodriguez - Executive Director & Head of School

@shiningstarspcs / PK3-6

- Global Citizenship  
Engage children where they are and grow outward to different cultures
- Experiential Learning  
Bring lessons to children while they engage with what interests them outside
- Diversity and Inclusion  
Learn to co-exist with people who are different from you
- Safety  
Facilitate outdoor learning to reduce viral transmission and enable social distancing





# Shining Stars Montessori Academy

## Learning opportunities:

- How healthy soil is made
- The role of worms and insects in nature
- The importance of reusing resources
- The importance of composting
- What helps plants grow
- The life cycle of the garden



Individual classrooms, Primary through Upper Elementary, coordinate with our parent gardening volunteers to work outdoors with the children. In addition, there is support work for parents who would like to participate in maintaining this exciting program.



# Shining Stars Montessori Academy

## Pre-COVID Uses



### **Gardening**

Active gardening and composting classes make use of raised beds and atrium garden areas

### **Local Partnerships**

The Capital Area Food Bank delivers fresh veggies for families to take home

### **Parent Support**

An active group of parents provide volunteer support and serve on the board

### **Off-Campus Outdoor Resources**

The nearby Franciscan Monastery makes their grounds available for excursions



# Shining Stars Montessori Academy

## Post-COVID Uses



### **Tentative Interest in Outdoor Meals**

Concerns regarding leaves and hand washing have prevented outdoor meals

### **Parent Gathering**

Parents are not allowed in the building, so outdoor gathering for parents is important

### **Outdoor Equipment**

Umbrellas have been procured for the outdoor atrium space to provide shade

### **Closed Play Equipment**

The play equipment in the playground is roped off due to viral transmission concerns





# Shining Stars Montessori Academy

## About the Project



The philosophy of Montessori encourages outdoor and experiential learning.

The school prefers neutral colors in the learning environment.

This site design is divided into four areas, which could each be built in phases, or at the same time. Short term recommendations include adding movable seating, worktables, and installing whiteboards.

These improvements alone will activate the spaces for learning.

Long term recommendations include re-imagining the playground with shade sails and integrated natural play and learning features.

Another long-term project is building out a full learning lab connected and integrated with the existing garden, including building new fencing around the 13th Street Corner.



# Shining Stars Montessori Academy

## Map Key

- 1** **ATRIUM** ☼  
Add small features like math counters, movable seats, bird feeders & birdhouse
- 2** **PLAYGROUND** ☼  
2a: Natural play area  
2b: Assembly area  
2c: Outdoor classrooms

- 3** **GARDEN** ☼  
Add work tables, veggie board signage, and a veggie farm stand weigh station
- 4** **13TH STREET CORNER** ☼  
Create a learning lab with split rail fencing, outdoor whiteboard, in-ground benches, earth science station, and weather station

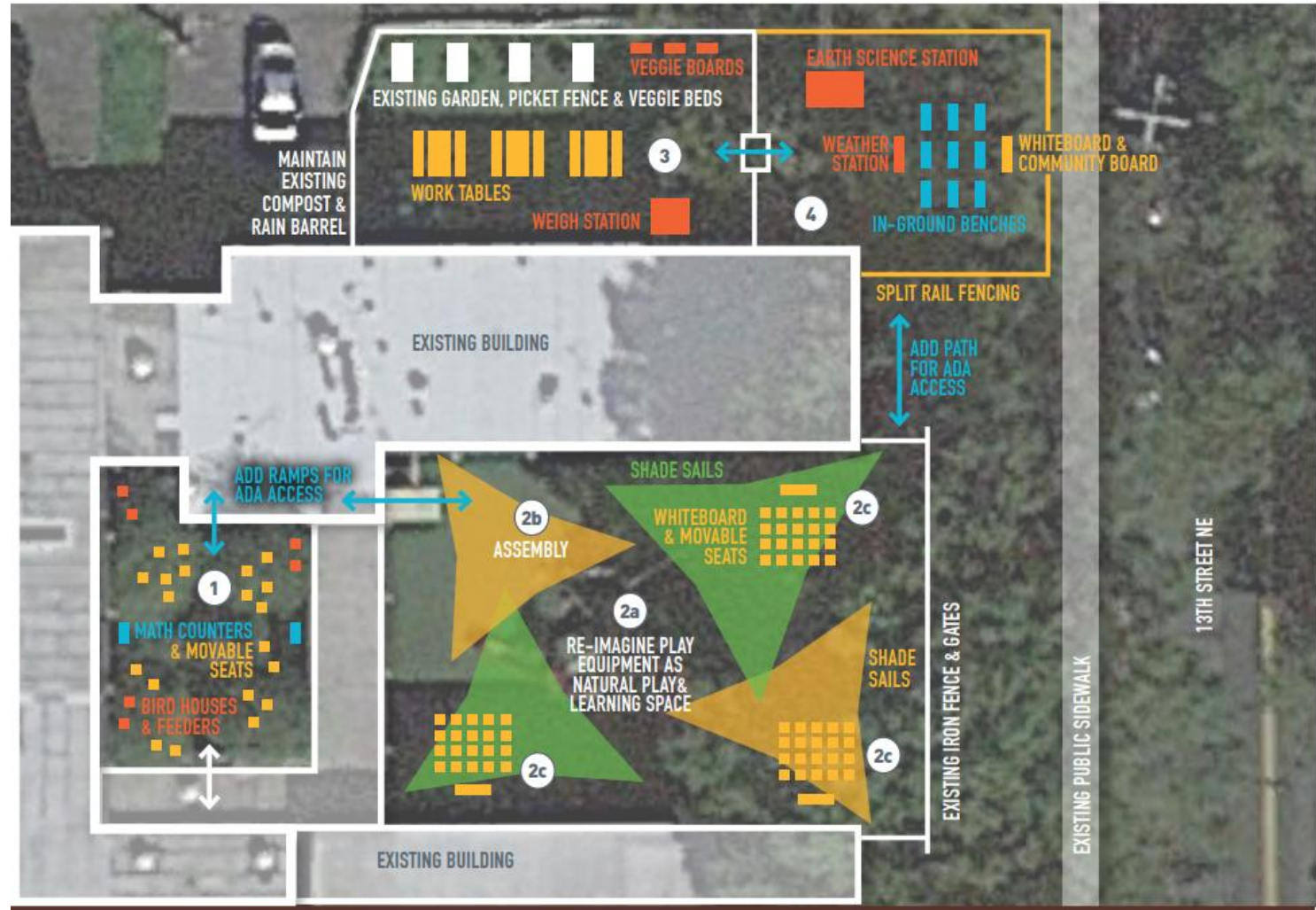



# Shining Stars Montessori Academy



Thank you to the leadership at Shining Stars Montessori Academy, for participating in the Technical Assistance Program. Engaging teachers, students, and families through outdoor learning!





# Shining Stars Montessori Academy



“Children indeed love flowers, but they need to do something more than remain among them and contemplate their colored blossoms. They find their greatest pleasure in acting, in knowing, in exploring, even apart from the attraction of external beauty.”

Dr. Maria Montessori



# Disclaimer

The contents of this document were developed under a grant from the United States Department of Education. However, those contents do not necessarily represent the policy of the United States Department of Education, and you should not assume endorsement by the Federal Government.